



SERVICE

LUBRICANTS

ELECTRICAL

IGNITION

FUEL

COOLING

ENGINE

GASKETS

DRIVE



2

YEAR

PARTS & LABOR
WARRANTY

Mallory

MARINE PRODUCTS

®

**2014 NEW PRODUCT &
RESOURCE GUIDE**

All oil is NOT created equal.

Mallory Marine offers a full line of quality,
high performance oils and lubricants
for the marine market.



See our web site for details
www.mallorymarine.com



Quality you can trust.

SERVICE TOOLS	PAGE
Adapters, Gearcase Filler	4
Funnels	4
Pullers	4
OUTBOARD FUEL SYSTEM PARTS	PAGE
Bulk Fuel Line	5
Fuel Hose Assemblies, Universal	5
Fuel Pump, Electric.....	6
FUEL WATER SEPARATING FILTER GUIDE	PAGE
Filter Kits	7
Replacement Cartridges	7
OUTBOARD COOLING SYSTEM	PAGE
Impellers	8
Water Pump Kit	8
OUTBOARD ENGINE PARTS	PAGE
Control Box Parts	9
Oil Filter.....	9
Switch, Oil Pressure.....	9
INBOARD & STERNDRIVE FUEL SYSTEM PARTS	PAGE
Carburetors, Remanufactured	12-13
Fuel Pump, Diesel	10
Fuel Pump, Electric.....	10
Gasket.....	10
IAC Motor	10
INBOARD & STERNDRIVE ENGINE PARTS	PAGE
Air Filters, Diesel.....	15
Switch, Oil Pressure.....	15
INBOARD & STERNDRIVE GASKETS	PAGE
Gasket Sets	16
Oil Seal, Rear Main.....	16
INBOARD & STERNDRIVE DRIVE SYSTEM PARTS	PAGE
Bearing, Gimbal.....	17
Transmission Gasket Kit	17
Transom Seal Kits.....	17
QUICK REFERENCE	PAGE
OEM & Competitive Interchange / Index.....	19
Numerical Index.....	21



9-81005
Adapter, Gearcase Filler
Fits: Suzuki & Mariners (Japan)



9-81006
Adapter, Gearcase Filler
Fits: OMC & Volvo Dual Prop



9-81007
Adapter, Gearcase Filler
Fits: OMC, Small Applications



9-79832
Tool, Universal Puller



9-79833
Tool, Flywheel Puller
Fits: Mercury



9-79834
Tool, Lifting Eye
Fits: Johnson/Evinrude V4 & V6



9-79826
Funnel, 6 Quart Heavy Duty
(With Screen)



9-79827
Funnel, 2 Quart Heavy Duty
(With Screen)

TECH TIP:

When using pullers and lifting eyes make sure everything is in alignment and all fasteners are properly installed before applying any torque or load. Improper alignment is the number one cause of failure when using these types of tools. One more thing please WEAR EYE PROTECTION.





MALLORY MARINE UNIVERSAL FUEL HOSE ASSEMBLIES

- Both Fuel Hose & Bulb surpass EPA regulations for less than 15 grams/m2/day permeation rate
- Extreme cold weather performance – fuel bulb requires 50% less effort while hose exhibits rope like flexibility
- Exceeds ABYC H-24, SAE J1527, ISO 8469 B1 and USCG Type B1-15
- NMMA Type accepted and CE certified
- Works with E10 and E15
- Comes with two Crimp Type Stepless Clamps for a clean Professional leak proof installation

MALLORY MARINE BULK FUEL HOSE

- Barrier Liner – fuel doesn't come in contact with rubber which helps stop ethanol degradation
- Surpass EPA regulations for less than 15 grams/m2/day permeation rate
- Exceeds ABYC H-24, SAE J1527, ISO 8469 B1 and USCG Type B1-15
- NMMA Type accepted and CE certified
- Not only works with E10 and E15 but with E85 and diesel fuel up to 100% bio diesel
- Operating Temperature Range – from -20°F to 212°F



UNIVERSAL FUEL HOSE ASSEMBLIES

9-38120

Fuel Hose Universal, Type B1-15
8' Fuel Hose Assembly
5/16", With Primer Bulb

9-38140

Fuel Hose Universal, Type B1-15
8' Fuel Hose Assembly
3/8", With Primer Bulb

9-38121

Fuel Hose Universal, Type B1-15
12' Fuel Hose Assembly
5/16", With Primer Bulb

9-38141

Fuel Hose Universal, Type B1-15
12' Fuel Hose Assembly
3/8", With Primer Bulb

BULK FUEL LINE

9-38110

Fuel Hose, Type B1-15
50' Spool, 5/16"

9-38111

Fuel Hose, Type B1-15
50' Spool, 3/8"



OUTBOARD FUEL SYSTEM PARTS



9-35441

Fuel Pump, Electric

Replaces: Yamaha 67H-13907-00-00

Fits: 2002-05 150-225HP w/ VST

TECH TIP:

Once fuel phase separation has occurred it cannot be reversed. You may be tempted to remove the water and use the fuel that remains.

DON'T!

The fuel that is left will be so degraded that it may cause detonation resulting in catastrophic engine failure.



9-79816

Mallory Marine
Fuel Tester



FUEL WATER SEPARATING FILTER GUIDE



WATER SEPARATING FUEL FILTERS

Mallory's Fuel Water Separating Filters provide excellent protection for your engines fuel system that no engine should be without. If your engine is not protected by a Mallory Filter you could risk being stranded due to water in your fuel system or possible damage to your fuel system components from corrosion. Mallory Fuel Filters are constructed to meet or exceed all OEM specifications.

Fuel Filter Features:

- 10 Micron Rating for 9-37800, 9-37801, 9-37810 & 9-37811 (required for many newer EFI & DFI engines)
- Epoxy coated interior for superior interior corrosion protection
- Premium quality filter media removes 98.8% of emulsified water and contaminants
- High flow capacity exceeds OEM specifications
- Heavy wall canister for superior crush resistance
- Will not remove 2 cycle oil from fuel
- Not for use with Diesel Fuel
- Recommended for all Outboards and I/O's except 1992 4.3L Mercruiser w/inline fuel filter



WILL NOT VOID YOUR ENGINE WARRANTY

10 MICRON APPROVED FOR USE WITH ETHANOL FUELS

Kits available w/ powder coated aluminum mounting bracket or 316 stainless steel and 1/4" or 3/8" NPT inlet/outlet



FUEL WATER SEPARATING FILTER GUIDE



FUEL WATER SEPARATOR REPLACEMENT FILTER CARTRIDGES

Mallory #	Description	Replaces OEM Models	Year(s) or Serial #	OEM Part #	Application
9-37800	Fuel Water Separating Filter	Mercury / Honda / Suzuki / Yamaha / Volvo / OMC / Many Others	Universal	35-802893Q / 35-807172	short canister
9-37801	Fuel Water Separating Filter	Mercury / Honda / Suzuki / Yamaha / Volvo / OMC / Many Others	Universal	35-807172	long canister
9-37803	Fuel Water Separating Filter	Johnson/Evinrude/OMC	n/a	502905	OMC
9-37804	Fuel Water Separating Filter	Johnson/Evinrude/OMC/Volvo	n/a	502906 / 385121B1 / 3862228	Direct Injection Outboards 90-115 hp 1998-up, 150-225 1999-up, Volvo and OMC EFI Inboard engines
9-37805	Fuel Water Separating Filter	Mercury	n/a	35-18458Q3	V-6 EFI/DFI 1995-earlier
9-37806	Fuel Water Separating Filter	Mercury	n/a	35-18458Q4	V-6 EFI/DFI 1996-newer
9-37807	Fuel Water Separating Filter	Yamaha	Universal	MAR-FUELF-IL-TR	High Capacity
9-37808	Fuel Water Separating Filter	Yamaha	Universal	MAR-MINIF-IL-TR	115 HP & Below
9-37810	Fuel Water Separating Filter	Racor	Universal	Racor S3227 & S3228UL, Honda 17670-ZW1-801AH, Suzuki 99105-20005, Yamaha MAR24563-00-00, Volvo 857633	For use with metal & plastic bowls fits Racor Head
9-37811	Fuel Water Separating Filter	Racor	Universal	Racor S3213 & S3220UL	For use with metal & plastic bowls – fits Mallory and most aftermarket filter brackets
9-37812	Fuel Water Separating Filter	Racor	Universal	Racor S3240, Honda 17670-ZW1-030GH, Suzuki 99105-20006	For use with Racor Filter Head & Bowl

FUEL WATER SEPARATOR FILTER KITS

Mallory #	Description	Replaces OEM Models	Year(s) or Serial #	OEM Part #	Application
9-37850	Fuel Water Separator Kit, aluminum brkt w/ 1/4" NPT inlet/outlets	Mercury/Mercruiser / Honda/ Suzuki / Yamaha / Volvo / Others	Universal	Mercury/Mercruiser 35-802893Q4/ Honda/ Suzuki 99105-2001/ Yamaha ABA-SEPAR-AT-OR/Others	Short canister
9-37851	Fuel Water Separator Kit, aluminum brkt w/ 1/4" NPT inlet/outlets	Mercury/Mercruiser / Honda/ Suzuki / Yamaha / Volvo / Others	Universal	Mercury/Mercruiser 35-802893Q4/ Honda/ Suzuki 99105-2001/ Yamaha ABA-SEPAR-AT-OR/Others	Standard canister
9-37852	Fuel Water Separator Kit, aluminum brkt w/ 3/8" NPT inlet/outlets	Mercury/Mercruiser / Honda/ Suzuki / Yamaha / Volvo / Others	Universal	Mercury/Mercruiser 35-802893Q4/ Honda/ Suzuki 99105-2001/ Yamaha ABA-SEPAR-AT-OR/Others	Standard canister
9-37855	Fuel Water Separator Kit, 316 Stainless Steel brkt w/ 1/4" NPT inlet/outlets	Mercury/Mercruiser / Honda/ Suzuki / Yamaha / Volvo / Others	Universal	Mercury/Mercruiser 35-802893Q4/ Honda/ Suzuki 99105-2001/ Yamaha ABA-SEPAR-AT-OR/Others	Standard canister
9-37856	Fuel Water Separator Kit, 316 Stainless Steel brkt w/ 3/8" NPT inlet/outlets	Mercury/Mercruiser / Honda/ Suzuki / Yamaha / Volvo / Others	Universal	Mercury/Mercruiser 35-802893Q4/ Honda/ Suzuki 99105-2001/ Yamaha ABA-SEPAR-AT-OR/Others	Standard canister
9-37880	Visi-Bowl kit for O/B Applications	Racor 320-R-RAC-01	Universal - Outboard Applications Only	N/A	10 micron filter element w/brkt & clear bowl
9-37881	Drain-a-Bowl kit for I/O Applications	Racor 320-R-RAC-01	Universal - Inboard Applications	N/A	10 micron filter element w/brkt & Metal bowl
9-37882	Visi-Bowl Filter & Bowl kit for O/B Applications	Universal	Universal - Outboard Applications Only	N/A	10 micron filter element & clear bowl Fits Mercury and most aftermarket filter brackets
9-37883	Drain-a-Bowl Filter & Bowl kit for I/O Applications	Universal	Universal - Inboard Applications	N/A	10 micron filter element & metal bowl Fits Mercury and most aftermarket filter brackets
9-37886	Fuel Water Separator Kit, 316 Stainless Steel brkt w/ 1/4" NPT inlet/outlets	Universal	Universal - Outboard Applications Only	N/A	10 micron filter element w/brkt & clear bowl
9-37887	Fuel Water Separator Kit, 316 Stainless Steel brkt w/ 3/8" NPT inlet/outlets	Universal	Universal - Outboard Applications Only	N/A	10 micron filter element w/brkt & clear bowl



OUTBOARD COOLING SYSTEM



9-45404

Impeller

Replaces: Nissan/Tohatsu 353650210M
Fits: 2002-up NS50C, NS60A, NS70A2



9-45505-10

Impeller (Bulk Pkg 10)

Fits: Suzuki DT100 1990-up



9-45617

Impeller

Replaces: Yamaha 6CE-44352-00-00
Fits: 2006-up 4-Stroke F225, F250, F300 (4.2L)



9-45616

Impeller

Replaces: Yamaha 6AW-44352-00-00
Fits: 2006-up 4-Stroke 300 & 350 HP (V8)

9-48620

Water Pump Kit (w/o Housing)

Replaces: Yamaha 6P2-W0078-00-00
Fits: 4-Stroke F250, F250B



TECH TIP:

When installing an impeller always lubricate it with a water soluble lubricant. Grease and oil will have an adverse effect on rubber and will lessen the life expectancy of the impeller.



9-57826

Marine Oil Filter

Replaces: BRP 420956741

Fits: All BRP 4-Stroke



9-57992

Switch, Oil Pressure

Replaces: Mercury 87-8280401

Fits: Mercury 25-60 HP



9-71102

OMC Control Box, Repair Kit

Contains Both Cam & Lever

DID YOU KNOW?

All oil filters are not created equal.

Mallory Marine oil filters are specifically designed to meet the requirements of the engines they are designed for.

- High Efficiency Filter Media – Removes harmful particles from your engines oil to prevent premature wear of bearings and other internal engine components.
- High Filtration Capacity – Holds up to 45% more dirt than other National leading brands.
- Engineered to meet or exceed OEM specifications





INBOARD & STERNDRIVE FUEL SYSTEM PARTS

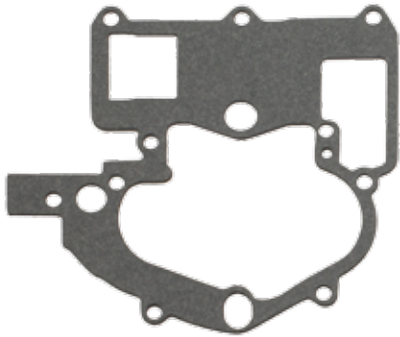

9-61013

Gasket, Air Horn

Replaces: Mercruiser 3310-866146002
Fits: MerCarb 2 Barrel (TKS)



9-35442

Fuel Feed Pump, Diesel
Replaces: Volvo 859428

Fits: Late 2000 Series Diesel Engines



9-33404

IAC Motor

Replaces: Mercruiser 862998
Fits: MCM 3.0, 4.3, 5.0, 5.7, 6.2, 8.2 (w/ Throttle Body)



9-35443

Fuel Feed Pump, Diesel
Replaces: Volvo 3582310

Fits: D30, D40, D31, D41, D42 Diesel Engines



9-35441

Fuel Pump, Electric

Replaces: Mercruiser 808505T01
Fits: 1994-1997 GM BB VST



9-35444

Fuel Feed Pump, Diesel
Replaces: Volvo 858459

Fits: Older D21 & D32 Diesel Engines



IMPROVED & UPDATED CARBURETOR PROGRAM



MALLORY MARINE CARBURETORS

- Each Carburetor is Remanufactured by Certified Technicians Using the Most Up-To-Date Components Available Today
- All Components are Cleaned, Remanufactured or Replaced to Meet O.E.M Specifications
- A Protective Zinc Plating is Applied to all Hardware and Linkage
- All Carburetors are Calibrated for Today's Gasoline Eliminating Problems on Older Engines such as:
 - Poor Idle
 - Hesitation
 - Hard Starting
 - Flat Spots
- Rochester, Weber & Holley models available
- Electric choke option available on many models

ALL NEW PART #S & PACKAGING!



A 3 Step Testing
Procedure is Done
on Every Unit to
Help Simplify
the Installation
Process:

- 1** Float Check & Pump Test
- 2** Dyno Flow Bench Test
- 3** **LIVE** Engine Test





INBOARD & STERNDRIVE FUEL SYSTEM PARTS



UNIVERSAL REMANUFACTURED CARBURETORS

ENGINE SIZE	CYLINDER	CARB TYPE	OUR PART #
Universal	8	Holley 2 BBL	9-34079
GM 5.0/5.7	8	Holley 4 BBL	9-34092

MERCRUISER REMANUFACTURED CARBURETORS

ENGINE SIZE	YEARS	CYLINDER	ORIGINAL OEM PART #	CARB TYPE	CHOKE	OUR PART #
2.5, 3.0	1963-82	4	1347-8186191	Rochester 2 BBL		9-34064
488, 180, 190, 3.7L, 205, 4.3L	1985-91	4, 6	3304-9354A2	Rochester 4 BBL		9-34070
488, 180, 190, 3.7L, 205, 4.3L	1985-91	4, 6	3304-9354A2	Rochester 4 BBL	Electric Choke	9-34083
205/ 4.3L	1985-91	6	3304-9565	M2/Mercarb	Electric Choke	9-34067
228-230 5.0 L	1977-87	8	3310-807312A1	M2/Mercarb	Electric Choke	9-34068
228-230 5.0 L	1977-87	8	1347-9661A3	Rochester 4 BBL		9-34069
228-230 5.0 L	1977-87	8	1347-9661A3	Rochester 4 BBL	Electric Choke	9-34082
888, 302 Ford	1971-77	8	1376-8186221	Rochester 2 BBL		9-34065
5.7L	1975-93	8	1347-8289A1	Rochester 4 BBL		9-34071
5.7L	1975-93	8	1347-8289A1	Rochester 4 BBL	Electric Choke	9-34084
5.7	1991-97	8	3310-807262A2	Weber		9-34073
5.7, 5.7 Ski	1996-97	8	3310-807312A1	M2/Mercarb		9-34066
7.4 L	1981-92		1347-8291A3	Rochester 4 BBL		9-34072
7.4 L		8	1347-8291A3	Rochester 4 BBL	Electric Choke	9-34085
7.4	1995-97	8	3310-806969A1	Weber		9-34074

OMC REMANUFACTURED CARBURETORS

ENGINE SIZE	YEARS	CYLINDER	ORIGINAL OEM PART #	CARB TYPE	OUR PART #
3.8L, 4.3 L	1979-89	6	983855	Rochester 4 BBL	9-34076
5.0L	1970-89	8	982223	Rochester 4 BBL	9-34077
Ford 302		8		Holley 4 BBL	9-34090
5.7L	1970-89	8	982223	Rochester 4 BBL	9-34078
Ford 351		8		Holley 4 BBL	9-34091



INBOARD & STERNDRIVE FUEL SYSTEM PARTS



PMC REMANUFACTURED CARBURETORS

ENGINE SIZE	CYLINDER	CARB TYPE	OUR PART #
Ford 302	8	Holley 4 BBL	9-34090
Ford 351	8	Holley 4 BBL	9-34091

VOLVO REMANUFACTURED CARBURETORS

ENGINE SIZE	YEARS	CYLINDER	CARB TYPE	CHOKE	OUR PART #
4.3L	All	6	Rochester 4 BBL	Electric Choke	9-34086
5.0 L	All	8	Rochester 4 BBL	Electric Choke	9-34087
Ford 302		8	Holley 4 BBL		9-34090
5.7L	All	8	Rochester 4 BBL	Electric Choke	9-34088
Ford 351		8	Holley 4 BBL		9-34091
7.4L	All	8	Rochester 4 BBL	Electric Choke	9-34089

SERVICE, QUALITY, VALUE PERFORMANCE

No matter what your service or maintenance needs may be, Mallory Marine has the right part at the right price with unparalleled quality and performance. Spend less money on repairs and more time on the water.



Mallory Marine has The Best
Warranty in the Industry!



WWW.MALLORYMARINE.COM



DID YOU KNOW?

**Mallory Marine introduced over 180
NEW products last season!**

DID YOU KNOW?

**Out of those 180 new products over 100 are
for Yamaha applications and the majority of
those are unique to Mallory Marine!**

DID YOU KNOW?

**Mallory Marine is the Aftermarket
LEADER when it comes to Yamaha
Service components!**

Visit www.mallorymarine.com for more information.



9-57703

Air Filter

Replaces: Yanmar 128270-12540
Fits: 2GM & 3GM30



9-57704

Air Filter

Replaces: Yanmar 128171-12540
Fits: 1GM10



9-57991

Oil Pressure Switch

Replaces: Mercruiser 87-864252
Fits: MCM 4.3, 5.0, 5.7



TECH TIP:

Mallory Marine water circulating pumps:

- Meets all OEM dimensional specifications
- High quality castings with premium coatings to resist corrosion
- Marine grade brass impellers, fittings, and plugs
- Stainless Steel backing plates (where applicable)
- Highest quality seal available for extended service life. Our seal utilizes a carbon phenolic primary ring and nitrile billows to resist chemical and harsh conditions better than the competition
- All mounting gaskets are included





INBOARD & STERNDRIVE GASKETS & GASKET SETS



9-61709

Gasket Kit, Head & Intake
Fits: Mercruiser V8 Vortec



9-61712

Gasket Set, Short Block Lower
Fits: Mercruiser V6 Vortec

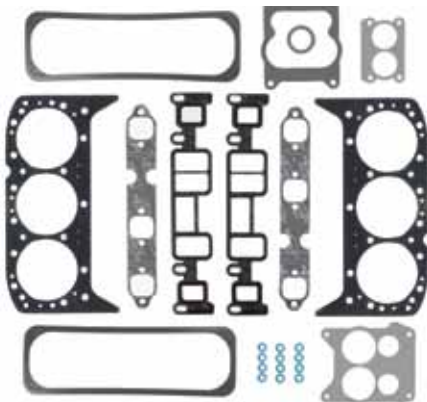

9-61710

Gasket Kit, Head & Intake
Fits: Mercruiser V6 Vortec



9-61629

Seal, Rear Main (1 pc)
Fits: 4.8, 5.3, 6.0 LS Engines

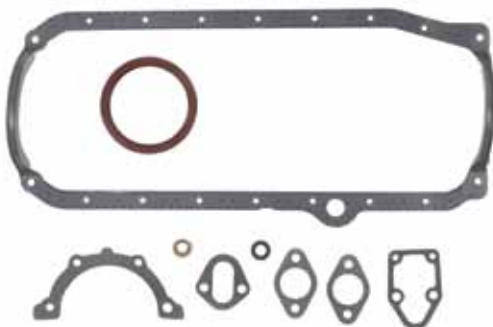

9-61711

Gasket Set, Short Block Lower
Fits: Mercruiser V8 Vortec

TECH TIP:



Always reference the proper service manual for the correct torque figures and the correct torque sequence. Mallory Marine offers a complete line of the Seloc Marine Service Manuals.



9-72906

Transom Seal Kit

Replaces: Mercruiser 30-803099T1

Fits: Alpha Gen II 1998-up
(Never Lube Gimbal Bearing)



9-72907

Transom Seal Kit

Replaces: Mercruiser 30-803100T1

Fits: Bravo I/II/III 1998-up
(Never Lube Gimbal Bearing)



9-72415

Gimbal Bearing, Never Lube

Replaces: Mercruiser 30-879194A01

Fits: 1998-up Alpha Gen II/ All Bravo

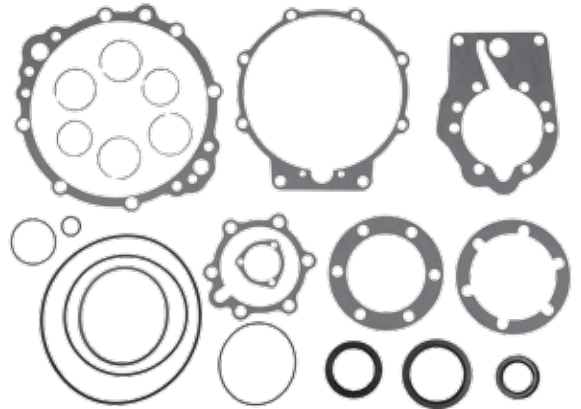

9-62620

Transmission Kit

Replaces: Borg Warner A4876HA

Fits: Velvet Drive 71/72 Series



Quality You Can Trust.

WWW.MALLORYMARINE.COM



MALLORY MARINE HAS THE PARTS, TOOLS & QUALITY TO MAKE YOU MORE PROFITABLE.

Mallory Marine is the leading supplier of quality engine and drive parts. We offer thousands of quality parts for every brand of Outboard, Inboard, & Sterndrive. No matter what your service or maintenance needs may be, Mallory Marine has the right part at the right price with unparalleled quality and performance.



*Ask your Mallory Marine distributor sales representative to show
you how he can help you increase your profitability.*



OEM & COMPETITIVE INTERCHANGE & INDEX

BORG WARNER #	Mallory #	Page #
A4876HA	9-62620	17
BRP #	Mallory #	Page #
420956741	9-57826	9
JOHNSON / EVINRUDE / OMC #	Mallory #	Page #
	9-34090	12
	9-34091	12
	9-71102	9
	9-79834	4
	9-81006	4
982223	9-34077	12
982223	9-34078	12
983855	9-34076	12
MERCURY MARINE #	Mallory #	Page #
	9-61709	16
	9-61710	16
	9-61711	16
	9-61712	16
	9-79833	4
	9-81005	4
862998	9-33404	10
808505T01	9-35441	10
87-8280401	9-57992	9
87-864252	9-57991	15
1347-8186191	9-34064	12
1347-8289A1	9-34071	12
1347-8289A1	9-34084	12
1347-8291A3	9-34072	12
1347-8291A3	9-34085	12
1347-9661A3	9-34069	12
1347-9661A3	9-34082	12
1376-8186221	9-34065	12
30-803099T1 (W/Never lube gimbal)	9-72906	17
30-803100T1 (W/Never lube gimbal)	9-72907	17
30-879194A01	9-72415	17
3304-9354A2	9-34070	12
3304-9354A2	9-34083	12
3304-9565	9-34067	12
3310-806969A1	9-34074	12
3310-807262A2	9-34073	12
3310-807312A1	9-34066	12
3310-807312A1	9-34068	12
3310-866146002	9-61013	10
NISSAN/TOHATSU #	Mallory #	Page #
353650210M	9-45404	8
PMC #	Mallory #	Page #
	9-34086	13

OEM & COMPETITIVE INTERCHANGE & INDEX



PMC #	Mallory #	Page #
	9-34087	13
	9-34088	13
	9-34089	13
	9-34090	12, 13
	9-34091	12, 13
SIERRA #	Mallory #	Page #
16-331-0386	9-38111	5
16-331-0566	9-38110	5
18-21006	9-72415	17
18-2590	9-62620	17
18-3515	9-48620	8
18-7603-1	9-34065	12
18-7604-1	9-34070	12
18-7605-1	9-34069	12
18-7609-1	9-34064	12
18-7611-2	9-34066	12
18-7613-1	9-34074	12
18-7615-1	9-34076	12
18-7615-1	9-34077	12
18-7615-1	9-34078	12
18-7618-1	9-34071	12
18-7701	9-33404	10
18-8013EP-1	9-38120	5
18-8015EP-1	9-38140	5
18-8032EP-1	9-38121	5
18-9795	9-81005	4
SUZUKI #	Mallory #	Page #
	9-45505-10	8
	9-81005	4
VOLVO #	Mallory #	Page #
	9-34090	12, 13
	9-34091	12, 13
	9-81006	4
	9-81007	4
858459	9-35444	10
859428	9-35442	10
3582310	9-35443	10
YAMAHA #	Mallory #	Page #
67H-13907-00-00	9-35441	6
6AW-44352-00-00	9-45616	8
6CE-44352-00-00	9-45617	8
6P2-W0078-00-00	9-48620	8
YANMAR #	Mallory #	Page #
128171-12540	9-57704	15
128270-12540	9-57703	15

Mallory #	OEM	OEM #	Page #
9-33404	MERCURY MARINE	862998	10
9-34064	MERCURY MARINE	1347-8186191	12
9-34065	MERCURY MARINE	1376-8186221	12
9-34066	MERCURY MARINE	3310-807312A1	12
9-34067	MERCURY MARINE	3304-9565	12
9-34068	MERCURY MARINE	3310-807312A1	12
9-34069	MERCURY MARINE	1347-9661A3	12
9-34070	MERCURY MARINE	3304-9354A2	12
9-34071	MERCURY MARINE	1347-8289A1	12
9-34072	MERCURY MARINE	1347-8291A3	12
9-34073	MERCURY MARINE	3310-807262A2	12
9-34074	MERCURY MARINE	3310-806969A1	12
9-34076	OMC	983855	12
9-34077	OMC	982223	12
9-34078	OMC	982223	12
9-34079			12
9-34082	MERCURY MARINE	1347-9661A3	12
9-34083	MERCURY MARINE	3304-9354A2	12
9-34084	MERCURY MARINE	1347-8289A1	12
9-34085	MERCURY MARINE	1347-8291A3	12
9-34086	VOLVO	Q-Jet w/elc choke; 4.3L All Yrs.	13
9-34087	VOLVO	Q-Jet w/elc choke; 5.0L All Yrs.	13
9-34088	VOLVO	Q-Jet w/elc choke; 5.7L All Yrs.	13
9-34089	VOLVO	Q-Jet w/elc choke; 7.4L All Yrs.	13
9-34090	OMC / VOLVO		12, 13
9-34091	OMC / VOLVO		12, 13



QUALITY YOU CAN TRUST.

www.mallorymarine.com

NUMERICAL INDEX



Mallory #	OEM	OEM #	Page #
9-34092			12
9-35441	MERCURY MARINE	808505T01	10
9-35441	YAMAHA	67H-13907-00-00	6
9-35442	VOLVO	859428	10
9-35443	VOLVO	3582310	10
9-35444	VOLVO	858459	10
9-38110			5
9-38111			5
9-38120			5
9-38121			5
9-38140			5
9-38141			5
9-45404	NISSAN/TOHATSU	353650210M	8
9-45505-10	SUZUKI		8
9-45616	YAMAHA	6AW-44352-00-00	8
9-45617	YAMAHA	6CE-44352-00-00	8
9-48620	YAMAHA	6P2-W0078-00-00	8
9-57703	YANMAR	128270-12540	15
9-57704	YANMAR	128171-12540	15
9-57826	BRP	420956741	9
9-57991	MERCURY MARINE	87-864252	15
9-57992	MERCURY MARINE	87-8280401	9
9-61013	MERCURY MARINE	3310-866146002	10
9-61629			16
9-61709	MERCURY MARINE		16
9-61710	MERCURY MARINE		16
9-61711	MERCURY MARINE		16
9-61712	MERCURY MARINE		16
9-62620	BORG WARNER	A4876HA	17
9-71102	JOHNSON / EVINRUDE / OMC		9
9-72415	MERCURY MARINE	30-879194A01	17
9-72906	MERCURY MARINE	30-803099T1 (W/Never lube bear)	17
9-72907	MERCURY MARINE	30-803100T1 (W/Never lube bear)	17
9-79826			4
9-79827			4
9-79832			4
9-79833	MERCURY MARINE		4
9-79834	JOHNSON / EVINRUDE		4
9-81005	MERCURY MARINE (Mariner)		4
9-81005	SUZUKI		4
9-81006	OMC		4
9-81006	VOLVO		4
9-81007	VOLVO		4

Check out our new display booth & trailer!



TECH TIP:

**DO YOU HAVE
ONE OF THESE?**

**THEN YOU NEED
ONE OF THESE?**

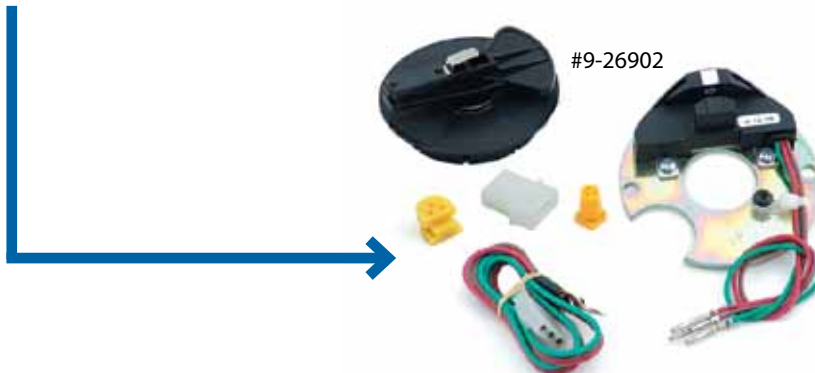



Point of Purchase & Merchandising Materials



#74636G
Ignition Wire Set Quick
Reference Guide

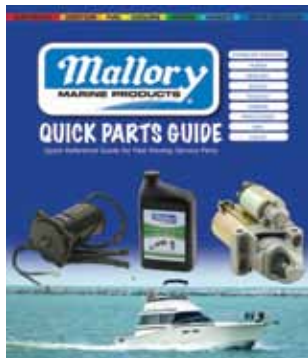

#74632G
Quick Parts
Reference Guide



#74634G
Engine Oil & Gearcase
Capacity Charts



#74546G
Inboard Oil Filter
Application Guide



#74547G
Outboard Oil Filter
Application Guide



#74548G
Water Separating Fuel Filter
Application Guide

#74653G - Oil & Lubricant POP Display Kit



- (1) Oils & Lubricants Header Card - 3 ft. x 9 in.
- (1) Oils & Lubricants Shelf Talker
- (4) Oils & Lubricants Shelf Edges

* Includes set up instructions and
74634G Quick Reference Guide

#74654G - Oil Filter POP Display Kit



- (1) Oil Filter Header Card - 3 ft. x 9 in.
- (1) Oil Filter Shelf Talker
- (2) Outboard Oil Filter Shelf Edges
- (1) Inboard Oil Filter Shelf Edges

* Includes set up instructions,
74546G and 74547G Quick Reference Guides

Point of Purchase & Merchandising Materials

#74655G - Water Separating Fuel Filter POP Display Kit



- (1) Fuel Filters & Kits Header Card - 3 ft. x 9 in.
- (1) Fuel Filters & Kits Shelf Talker
- (4) Fuel Filters & Kits Shelf Edges

* Includes set up instructions and 74548G Quick Reference Guide

#74656G - Ignition Wires POP Display Kit



- (1) Promaster® Ignition Wires Header Card - 3 ft. x 9 in.
- (1) Promaster® Ignition Wires Shelf Talker
- (4) Promaster® Ignition Wires Shelf Edges

* Includes set up instructions and 74636G Quick Reference Guide

Part #	Description
74636G	Ignition Wire Set Quick Reference Guide
74632G	Quick Parts Quick Reference Guide
74634G	Engine Oil & Gearcase Capacity Charts
74546G	Inboard Oil Filter Application Guide
74567G	Outboard Oil Filter Application Guide
74548G	Fuel Water Separator Filters Application Guide
74450G	Mallory Marine Banner
74652G	Wire Assortment POP Line Art Diagrams
74653G	Oil & Lube POP Display Kit
74654G	Oil Filter POP Display Kit
74655G	Fuel Filter POP Display Kit
74656G	Ignition Wire POP Display Kit

DEALER LOCATOR SERVICE



REQUIRED INFORMATION

Company _____

Street _____

City _____

State/Prov. _____ Zip/Postal _____

Published Local Phone # _____

Published 800 # _____

Fax # _____ ☐ No Fax

E-mail _____

Website **www.** _____

Contact _____ Title _____
First and last name

1. Primary Business Type (Check One)

- ☐ Sale and Service ☐ Engine Builder
☐ Service Only ☐ Mobile Service
☐ Retail Accessories ☐ Other (Please Describe) _____
☐ Marina _____

2. List 2 Primary Wholesale Distributor Suppliers

- 1) _____
 2) _____

3. Check the Types of Advertising This Store Uses

- ☐ Direct Mail ☐ Newspaper/Shopper
☐ Radio ☐ Flyer
☐ TV/Cable ☐ Magazines
☐ Internet ☐ Other _____

4. Questions About This Location

- A) # Employees: _____
 B) Business Started: _____
 C) # Square Feet: _____
 D) Approximate Annual Sales: _____

Factory Use - (circle answer) Date _____

A) Add to referral net: approved rejected By: _____

B) Remove from our referral network: (circle reason)

Out of Business No longer carries our products

Other _____

Mallory Marine's Online Dealer Locator Service helps consumers find their local dealer. By visiting our website, consumers can enter their zip code to find the dealer closest to them.

If your store stocks and sells our various product brands and you wish to be part of the Dealer Locator Service, complete this form and FAX it back to us at 216-688-8305. Even if you previously filled out a similar form a few years back, you need to complete and FAX this form.

Other than the two minutes it takes to fill out this form, there are no costs involved to be part of this service.

Sign up TODAY for more sales tomorrow!

PRODUCTS STOCKED AND SOLD

(check all that apply)

Lubricants _____

Electrical Parts _____

Ignition Parts _____

Fuel System Parts _____

Cooling System Parts _____

Engine Parts _____

Gaskets & Gasket Sets _____

Drive Parts _____



LIMITED WARRANTY POLICY

Mallory Marine is a trademark of Prestolite Performance

Mallory Marine hereby warrants to the original retail purchaser, subject to the limitations and conditions incorporated herein, that Mallory Marine Products are free from defects in material and workmanship for a period of two (2) years from the original retail purchase.

To obtain warranty service for a claim without labor, return the Mallory Marine product along with proof of the date of the original retail purchase, freight prepaid to the distributor from whom the product was purchased, the distributor will then forward the product to Mallory Marine for evaluation. If the product is determined by Mallory Marine to be eligible for warranty, Mallory Marine will credit the distributor and the Distributor will credit the selling dealer.

To obtain warranty service for a claim with labor, return the allegedly defective Mallory Marine product and any other related damaged parts, along with proof of the date of the original retail purchase, freight prepaid to: Mallory Marine, 10601 Memphis Ave. #12, Cleveland, OH 44144.

Product purchased and properly installed by a Qualified Dealer and determined by Mallory Marine to be defective, may be eligible for labor reimbursement. If the claim for warranty is determined by Mallory Marine to be valid Mallory Marine will advise the dealer of the extent of Mallory Marine's responsibility. Mallory Marine will settle all labor claims directly with the dealer. Credit for the defective parts and parts related to the warranty repair only, will be issued to the distributor. The distributor will then issue credit to the dealer.

The duties and obligations of Mallory Marine under this Limited Warranty are expressly limited to the repair or replacement (at the sole discretion of Mallory Marine) of Mallory Marine products, which, in the sole opinion of Mallory Marine, have been found to be covered under the terms and conditions of this Limited Warranty. Mallory Marine expressly disclaims any duty or obligation to repair or replace any product other than a Mallory Marine product.

This Limited Warranty shall become void if it is determined by Mallory Marine, in its sole discretion, that products submitted for warranty consideration failed due to normal wear, or show evidence of abuse, lack of proper maintenance, improper installation, misapplication, alteration in any way whatsoever from their original design or negligence in use. Mallory Marine reserves the right to extend only the fair market value on claims that cannot be rectified due to unavailability of replacements parts.

Mallory Marine expressly retains the right to make changes and improvements in any product that it manufactures and sells at any time, without notice and without any obligation to change the catalogs or printed matter. Mallory Marine retains the right to determine, in its sole discretion, whether or not any Mallory Marine product is covered by this Limited Warranty.

This Warranty is limited and expressly limits any implied warranty to two (2) years from the date of the original retail purchase on all Mallory Marine products and is nontransferable. Some states or countries do not allow limitations on how long an implied warranty lasts, so the above limitation may not apply to you.

No person, party or corporate entity other than Mallory Marine shall have the right to determine whether or not this Limited Warranty is applicable to any Mallory Marine product or to authorize any action whatsoever on behalf of Mallory Marine under the terms and conditions of this Limited Warranty. This Limited Warranty gives you specific legal rights, and you may also have other rights which may vary from state to state.

This Limited Warranty is in lieu of, and expressly excludes, any and all other warranties, express or implied, including any warranty of merchantability or of a fitness for a particular application or purpose.



DON'T GET LEFT IN THE WAKE!

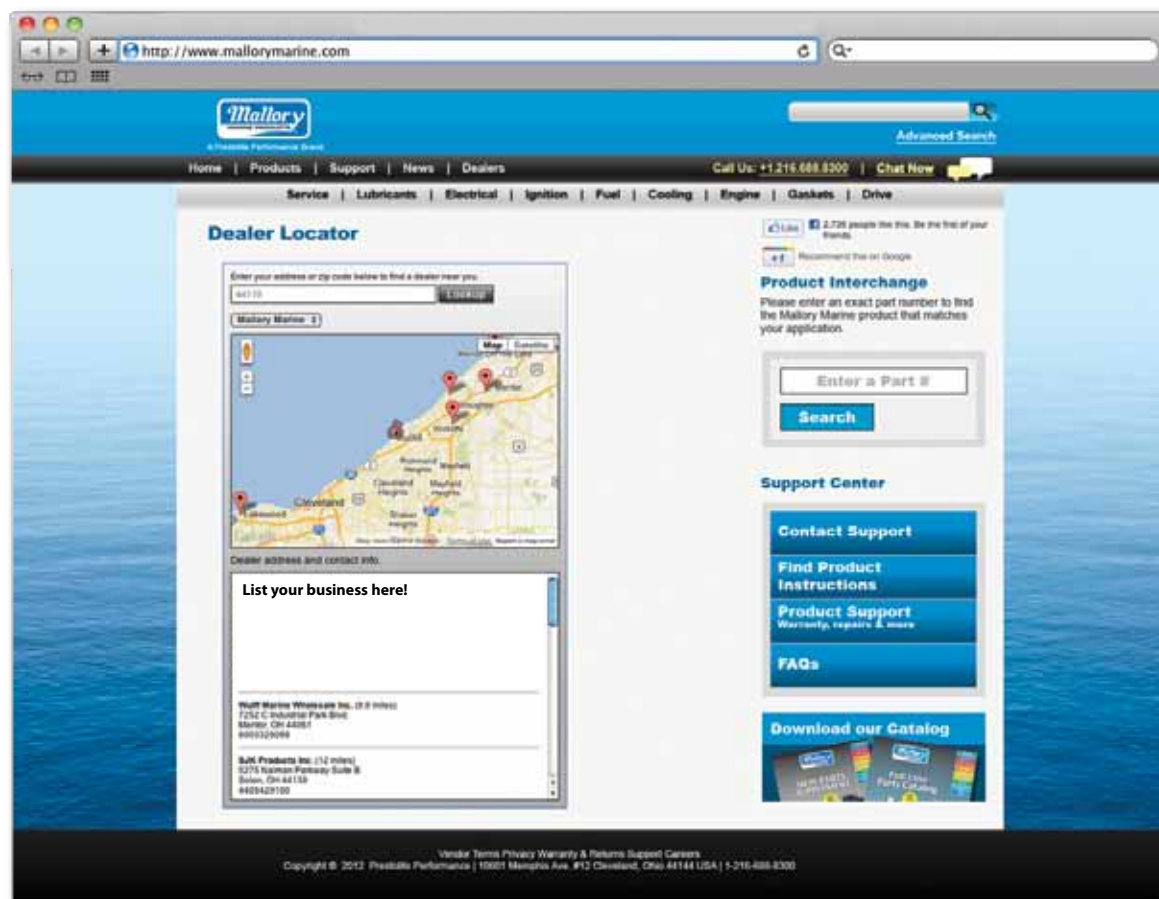

*Visit our website and register for our
FREE national dealer locator service!*

Visit our website at www.mallorymarine.com
for more information.

MALLORY MARINE TECH SERVICE: 216.658.6438

 **prestolite PERFORMANCE** family of brands
Mallory Marine is a trademark of Prestolite Performance, Cleveland, Ohio
©2013 www.mallorymarine.com 74775G

